

**41890 Majuba Hill Rd,
Chilliwack, BC**

Main: 2096 sq.ft.

Below: 2026 sq.ft.

Total: 4122 sq.ft.

JIM BRAICH

Licensed Real Estate Professional

604-859-3141

jimbraich@gmail.com

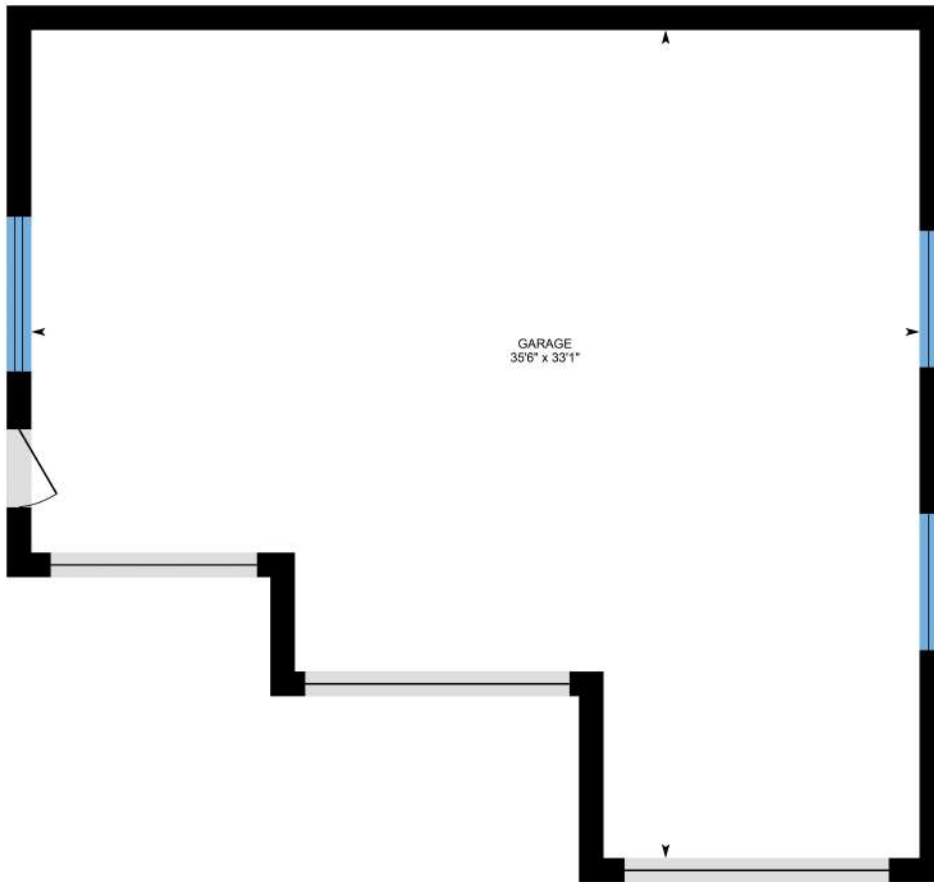

Detached Shop
(1092 sq ft)

Measured on: Aug12, 2022

White regions are excluded from total floor area in iGUIDE floor plans.
All room dimensions and floor areas must be considered approximate
and are subject to independent verification.

